

CLEANVALVE DE DIETRICH®



REDUCE YOUR MAINTENANCE COSTS

SAFETY - RELIABILITY



TIGHTNESS GUARANTEED BY A THREEFOLD SAFETY PROVISION

- Grinding of the glass-lined valve stem
- Sealing by PTFE chevron system + neck ring with O-Ring
- No re-tightening needed

COUPLING WITH REMOVABLE FRONT

Easy and fast disassembly / reassembly of the temperature sensor (even during the process)

CERTIFICATIONS

- TA LUFT, FIRE SAFE (option), PED
- Sealing level during operation
NF EN 12266 - **NEW**
- **SIL 2 - NEW, option**
- ATEX



CLEANING: no cross contamination

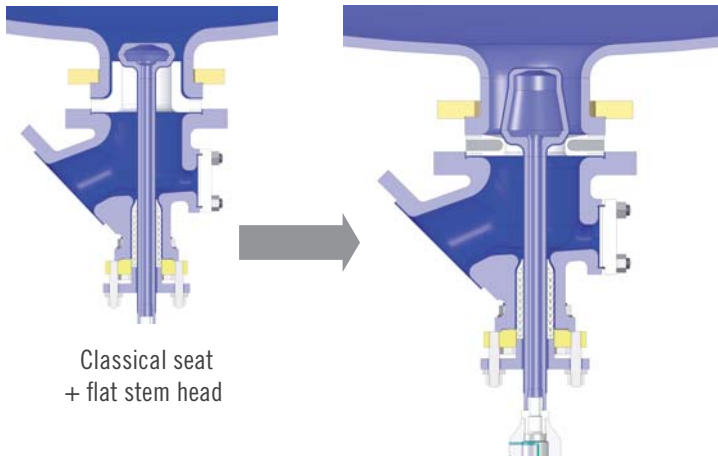

NEW PATENT: FLAT SEAT

Removes vertical leak path between seat and neck wall,
simple retrofit to existing outlets



THE SINGLE AND INNOVATIVE SOLUTION FOR OPTIMAL CLEANING

OPTIMAL CLEANING flow channel



LATERAL NOZZLE cleaning, sterilization, inerting



SPRAY BALL (option)



Retractable spray ball in PTFE



A FULL RANGE

Material:

- Enamel DD3009
- Stainless steel 1.4409 (316L)
- Alloy 2.4602 (C22)

Control:

- Manual
- Pneumatic axial / lateral
- Axial compact

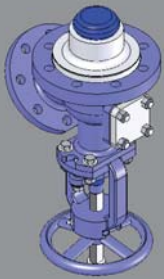

CVB



CVBP



CVBPL

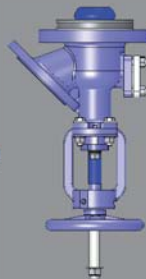

CVBSP



CVBPSP

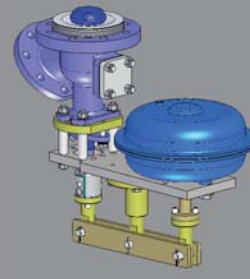

CVBPLSP

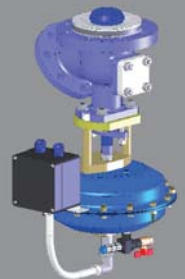

CVBPCSP

CVBP : Standard model shipped within 24 hours

- **Temperature** up to $-100^{\circ}/+200^{\circ}\text{C}$ (according to material and size)
- **Pressure** up to $-1/+25$ bar (according to material and size)

ACCESSORIES & OPTIONS

- Single action pneumatic control
- Sensors limit switches
- Positioner
- Temperature sensor 2 x Pt 100 Ohms
- Quick-exhaust valve for the pneumatic actuators
- Solenoid control valve
- Assembly / disassembly device
- Sightglass

